

## PRODUCT DATA SHEET

Published: 2026-06-29

Coolant valve  
with LiBus connection, 1/2" to 1/2"  
Part Number: LCZ 9664

### Features

- The cooling liquid valve is designed for operation with cooling water only.
- With the cooling liquid valve, the cooling water quantity can be controlled (on/off) by means of LiBus module, by opening the cooling water inlet only when cooling is required.
- Operation up to T = 155 °C possible.
- For safe operation of the cooling liquid valve with water above 100 °C, the free hose end of the cooling coil must be fixed at the outlet, as a steam blow may occur in the short

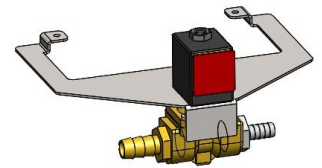

### Technical Features

Connection 1 thread (inside)	1/2"
Connection 2 thread (inside)	1/2"
Weight	0.90 kg

Reserve technical changes

LAUDA DR. R. WOBSEY GMBH & CO. KG  
Laudaplatz 1 • 97922 Lauda-Königshofen • DE

T + 49 (0) 9343 503-0  
info@lauda.de • www.lauda.de  
WEEE-Reg.-Nr.: DE 66 42 40 57

Kommanditgesellschaft: Sitz Lauda-Königshofen  
Registergericht Mannheim • HRA 560069

Persönlich haftende Gesellschafterin:  
LAUDA DR. R. WOBSEY Verwaltungs-GmbH  
Sitz Lauda-Königshofen  
Registergericht Mannheim • HRB 560226

Geschäftsführer:  
Dr. Gunther Wobsey (Vors.), Dr. Mario Englert,  
Dr. Marc Stricker  
Beirat: Dr. Gerhard Wobsey